

APPROVAL	SIGN	DATE
TOOLING MGR		
ENGG MGR		
OPERATIONS MGR		

Figure 1

FOR REVISION UPDATE PLEASE REFER TO HISTORY OF CHANGES.

Carsem Your Technology Partner

REV M	DWG NO: -MLPQHM-CPOD-0031	
	APP'D	-
	CHECKED	CC YIP
	DESIGNED	-
	DRAWN	KC LAU

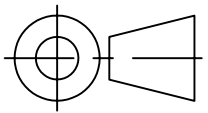

FILE:-MLPQHM-CPOD-0031-REVM
MLP QUAD HIGH DENSITY PACKAGE OUTLINE
PAGE : 1 of 9

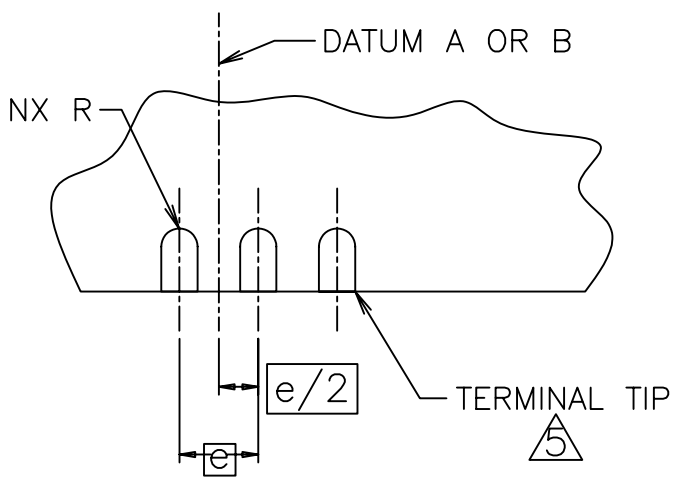

EVEN TERMINAL/SIDE

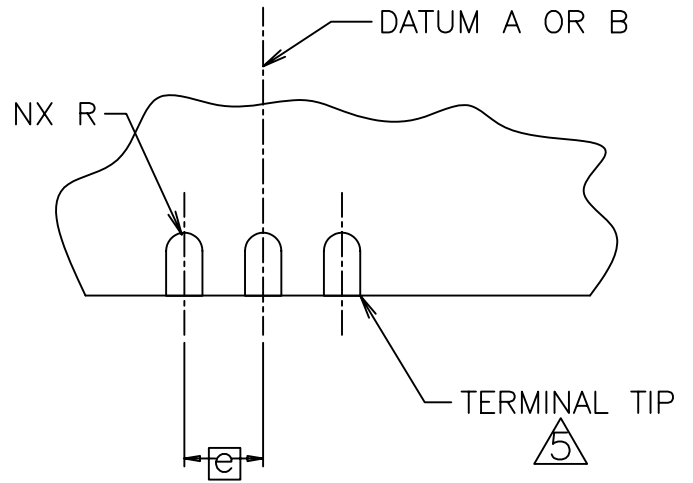

ODD TERMINAL/SIDE

DETAIL B

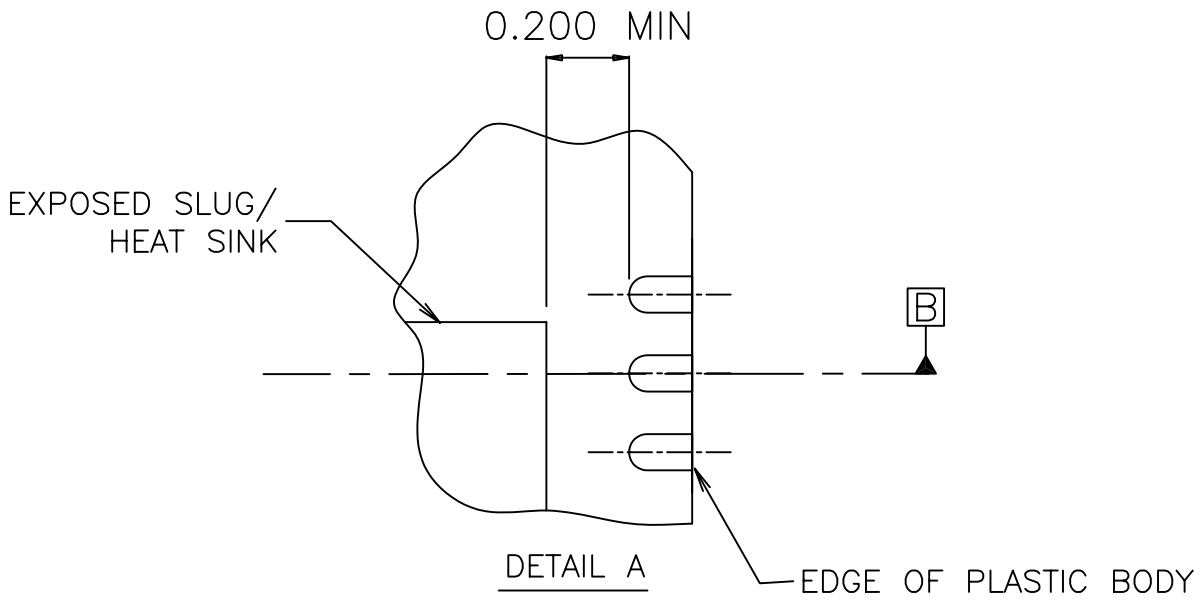

DETAIL A

THIS FEATURE APPLIES TO ALL QUADRANTS OF THE PKG.

FOR REVISION UPDATE PLEASE REFER TO HISTORY OF CHANGES.

 Carsem Your Technology Partner

REV
M

DWG NO: -MLPQHM-CPOD-0031	
APP'D	-
CHECKED	CC YIP
DESIGNED	-
DRAWN	KC LAU

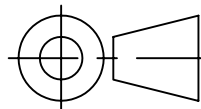

FILE: -MLPQHM-CPOD-0031-REVM
MLP QUAD HIGH DENSITY PACKAGE OUTLINE
PAGE : 2 of 9

TABLE 1



VARIATION DESIGNATORS

FIRST DIGIT CODE		SECOND DIGIT CODE		THIRD DIGIT CODE		FOURTH DIGIT CODE	
OVERALL HEIGHT		BODY LENGTH		BODY WIDTH		TERMINAL PITCH	
A	LETTER CODE	D	LETTER CODE	E	LETTER CODE	e	LETTER CODE
1.0 MAX	V	3	E	3	E	1.00	A
		4	G	4	G	0.80	B
		5	H	5	H	0.65	C
		6	J	6	J	0.50	D
		7	K	7	K	0.40	E
		8	L	8	L		

FOR REVISION UPDATE PLEASE REFER TO HISTORY OF CHANGES.



REV
M

DWG NO:	-MLPQHM-CPOD-0031
APP'D	-
CHECKED	CC YIP
DESIGNED	-
DRAWN	KC LAU

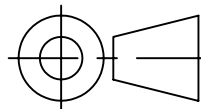

FILE:	-MLPQHM-CPOD-0031-REVM
MLP QUAD HIGH DENSITY PACKAGE OUTLINE	
PAGE : 3 of 9	

TABLE 2: COMMON HEIGHT DIMENSION

V-PROFILE HEIGHT 

BODY SIZE	3 X 3 4 X 4		5 X 5 7 X 7		10 X 10		
	DIM SYMBOL	MIN	NOM	MAX	MIN	NOM	MAX
A	0.80	0.83	0.90	0.80	0.90	1.00	
A1	0	0.02	0.05	0	0.02	0.05	
A2	0.58	0.63	0.68	0.65	0.70	0.75	
A3 REF	0.20			0.20			
θ	8°	10°	12°	8°	10°	12°	
NOTES	1,2						
REF							
ISSUE							

TABLE 3: TOLERANCE OF FORM AND POSITION

PITCH (MM) SYMBOL	
	0.50
aaa	0.15
bbb	0.10
ccc	0.10
ddd	0.05
NOTES	1,2
REF	
ISSUE	

FOR REVISION UPDATE PLEASE REFER TO HISTORY OF CHANGES.

 Carsem Your Technology Partner

REV
M

DWG NO:	-MLPQHM-CPOD-0031
APP'D	-
CHECKED	CC YIP
DESIGNED	-
DRAWN	KC LAU

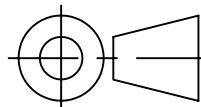

FILE:	-MLPQHM-CPOD-0031-REVM
MLP QUAD HIGH DENSITY PACKAGE OUTLINE	
PAGE : 4 of 9	

TABLE 4

SUMMARY TABLE			
BODY SIZE	LEAD PITCH	LEAD COUNT	VERY THIN PROFILE
3X3	0.50	12	VEED-5
3X3	0.50	16	VEED-6
4X4	0.65	16	VGGC-3
4X4	0.65	16	VGGC-NJ2
4X4	0.50	20	VGGD-11
4X4	0.50	20	VGGD-1
5X5	0.50	32	VHHD-5
7X7	0.50	48	VKKD-2
10X10	0.50	72	VNND-4

FOR REVISION UPDATE PLEASE REFER TO HISTORY OF CHANGES.



REV
M

DWG NO: -MLPQHM-CPOD-0031	
APP'D	-
CHECKED	CC YIP
DESIGNED	-
DRAWN	KC LAU

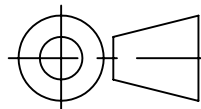

FILE:-MLPQHM-CPOD-0031-REVM
MLP QUAD HIGH DENSITY PACKAGE OUTLINE
PAGE : 5 of 9

TABLE 5

$$e = 0.50 \text{ PITCH}$$

VARIATION		VEED-5	VEED-6	VGGD-11	VHHD-5	VKGD-2	NOTE
SYMBOL							
b	MIN	0.18	0.18	0.18	0.18	0.18	
	NOM	0.23	0.23	0.23	0.23	0.20	
	MAX	0.28	0.28	0.28	0.28	0.25	
D BSC		3.00	3.00	4.00	5.00	7.00	
E BSC		3.00	3.00	4.00	5.00	7.00	
D1 BSC		2.75	2.75	3.75	4.75	6.75	
E1 BSC		2.75	2.75	3.75	4.75	6.75	
D2	MIN	1.40	1.40	2.40	3.35	5.05	
	NOM	1.50	1.50	2.50	3.45	5.15	
	MAX	1.60	1.60	2.60	3.55	5.25	
E2	MIN	1.40	1.40	2.40	3.35	5.05	
	NOM	1.50	1.50	2.50	3.45	5.15	
	MAX	1.60	1.60	2.60	3.55	5.25	
L	MIN	0.30	0.30	0.30	0.30	0.30	
	NOM	0.40	0.40	0.40	0.40	0.40	
	MAX	0.50	0.50	0.50	0.50	0.50	
R REF		0.12	0.12	0.12	0.12	0.10	
R1	MIN	0.15	0.15	0.15	0.15	0.15	
	NOM	0.20	0.20	0.20	0.20	0.20	
	MAX	0.25	0.25	0.25	0.25	0.25	
T REF		0.45	0.45	0.65	0.65	0.65	
N		12	16	20	32	48	3
ND		3	4	5	8	12	6
NE		3	4	5	8	12	6
NOTES		1,2,8	1,2,8	1,2,8	1,2,8	1,2,8	
REF							
ISSUE							

FOR REVISION UPDATE PLEASE REFER TO HISTORY OF CHANGES.

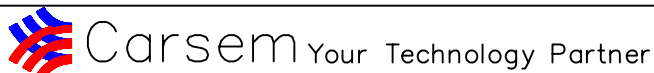

REV
M

DWG NO: -MLPQHM-CPOD-0031

APP'D	-
CHECKED	CC YIP
DESIGNED	-
DRAWN	KC LAU

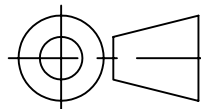

FILE: -MLPQHM-CPOD-0031-REVM

MLP QUAD HIGH DENSITY
PACKAGE OUTLINE

PAGE : 6 of 9

TABLE 6

$$e = 0.50 \text{ PITCH}$$

SYMBOL \ VARIATION		VGGD-1	VNND-4				NOTE
b	MIN	0.18	0.18				
	NOM	0.23	0.23				
	MAX	0.28	0.28				
D BSC		4.00	10.00				
E BSC		4.00	10.00				
D1 BSC		3.75	9.75				
E1 BSC		3.75	9.75				
D2	MIN	1.95	5.75				
	NOM	2.10	5.90				
	MAX	2.25	6.00				
E2	MIN	1.95	5.75				
	NOM	2.10	5.90				
	MAX	2.25	6.00				
L	MIN	0.50	0.35				
	NOM	0.60	0.40				
	MAX	0.70	0.45				
R REF		0.12	0.12				
R1	MIN	0.15	0.15				
	NOM	0.20	0.20				
	MAX	0.25	0.25				
T REF		0.65	0.45				
N		20	72				3
ND		5	18				6
NE		5	18				6
NOTES		1,2,8	1,2,8				
REF							
ISSUE							

FOR REVISION UPDATE PLEASE REFER TO HISTORY OF CHANGES.

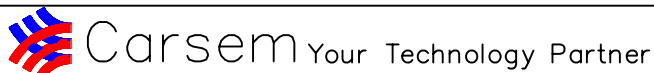

REV
M

DWG NO: -MLPQHM-CPOD-0031	
APP'D	-
CHECKED	CC YIP
DESIGNED	-
DRAWN	KC LAU

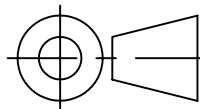

FILE: -MLPQHM-CPOD-0031-REVM
MLP QUAD HIGH DENSITY PACKAGE OUTLINE
PAGE : 7 of 9

TABLE 7

$$e = 0.65 \text{ PITCH}$$

VARIATION		VGGC-3	VGGC-NJ2				NOTE
SYMBOL							
b	MIN	0.25	0.25				
	NOM	0.30	0.30				
	MAX	0.35	0.35				
D BSC		4.00	4.00				
E BSC		4.00	4.00				
D1 BSC		3.75	3.75				
E1 BSC		3.75	3.75				
D2	MIN	2.40	2.20				
	NOM	2.50	2.30				
	MAX	2.60	2.40				
E2	MIN	2.40	2.20				
	NOM	2.50	2.30				
	MAX	2.60	2.40				
L	MIN	0.30	0.50				
	NOM	0.40	0.60				
	MAX	0.50	0.70*				
R REF		0.15	0.15				
R1	MIN	0.15	0.15				
	NOM	0.20	0.20				
	MAX	0.25	0.25				
T REF		0.65	0.45				
N		16	16				3
ND		4	4				6
NE		4	4				6
NOTES		1,2,8	1,2,8				
REF							
ISSUE							

FOR REVISION UPDATE PLEASE REFER TO HISTORY OF CHANGES.

 Carsem Your Technology Partner

REV
M

DWG NO:	-MLPQHM-CPOD-0031
APP'D	-
CHECKED	CC YIP
DESIGNED	-
DRAWN	KC LAU

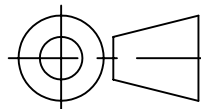

FILE:	-MLPQHM-CPOD-0031-REVM
MLP QUAD HIGH DENSITY PACKAGE OUTLINE	
PAGE : 8 of 9	

Note:

1. Dimensioning and tolerancing conform to ASME Y14.5M-1994.
2. All dimensions are in millimeters . All angles are in degrees.
3. N is the total number of terminals.

4. The terminal #1 identifier and terminal numbering convention shall conform to JESD 95-1 SPP-012. Details of terminal #1 identifier are optional , but must be located within the zone indicated. The terminal #1 identifier may be a molded, marked, or metalized features.

5. Dimensions b apply to metallized terminal and is measured between 0.15 and 0.30mm from terminal tip.

6. ND & NE refer to the maximum number of terminals on D and E side.

7. Variation VHHD is shown for illustration only.

8. For a complete set of dimensions for each variation, see the individual variation and the common dimensions and tolerances on page 4,5,6 & 7.

9. Coplanarity applies to the exposed heat sink slug as well as the terminals.

10. When more than one variation (option) exists for the same profile height, body size (D x E), and pitch, then those variations will be denoted by an additional dash number (ie: -1, -2, etc.) designator to identify them. The new variations would be created from all or any of the following reasons lead counts, terminal lengths, and or thermal pad sizes.

11. Variation comply to JEDEC MO-220 except "NJ" variations.

12. A3 is measured at side of the package in between two adjacent leads.

13. Dimensions with "*" are the deviations from JEDEC MO-220.

FOR REVISION UPDATE PLEASE REFER TO HISTORY OF CHANGES.

 Carsem Your Technology Partner

REV
M

DWG NO: -MLPQHM-CPOD-0031

APP'D

-

CHECKED

CC YIP

DESIGNED

-

DRAWN

KC LAU

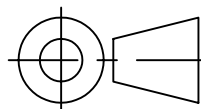

FILE:-MLPQHM-CPOD-0031-REVM

MLP QUAD HIGH DENSITY
PACKAGE OUTLINE

PAGE : 9 of 9