

Figure 1

APPROVAL	SIGN	DATE
TOOLING MGR		
ENGG MGR		
OPERATIONS MGR		

FOR REVISION UPDATE PLEASE REFER TO HISTORY OF CHANGES.

Carsem Your Technology Partner

REV
B

DWG NO:	-8MLPDH5X6M-CPOD-0039
APP'D	-
CHECKED	KC LAU
DESIGNED	-
DRAWN	WL ONG

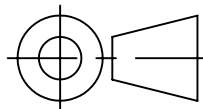

FILE:-8MLPDH5X6M-CPOD-0039-REVB

MLPDH 5X6 8L
PACKAGE OUTLINE
(CUCLIP)

PAGE : 1 of 5

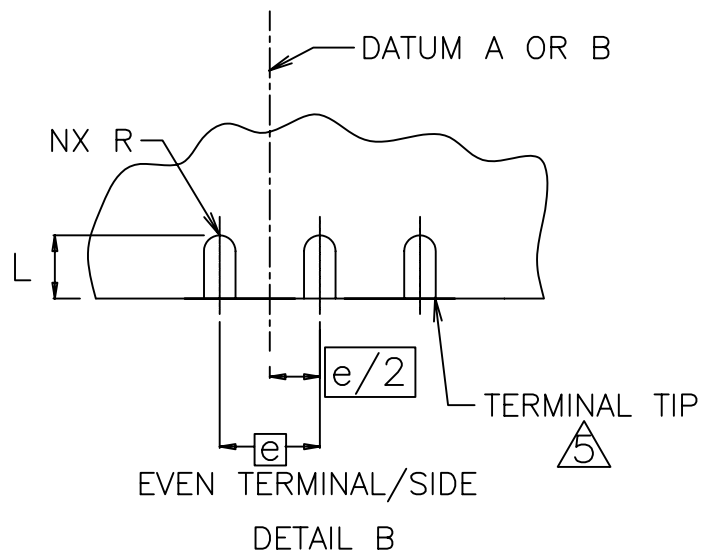

FOR REVISION UPDATE PLEASE REFER TO HISTORY OF CHANGES.

 Carsem Your Technology Partner

REV
B

DWG NO: -8MLPDH5X6M-CPOD-0039

APP'D	-
CHECKED	KC LAU
DESIGNED	-
DRAWN	WL ONG

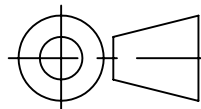

FILE:-8MLPDH5X6M-CPOD-0039-REVB

MLPDH 5X6 8L
PACKAGE OUTLINE
(CUCLIP)

PAGE : 2 of 5

TABLE 1: COMMON HEIGHT DIMENSION

V-PROFILE HEIGHT 

DIM SYMBOL	MIN	NOM	MAX
A	0.80	0.83	0.90
A1	0	0.020	0.05
A2	0.58	0.63	0.68
A3 REF	0.20		
θ	0°	10°	12°
NOTES	1,2		
REF			
ISSUE			

TABLE 2: TOLERANCE OF FORM AND POSITION

PITCH (MM) SYMBOL	1.270		
aaa	0.15		
bbb	0.10		
ccc	0.10		
ddd	0.05		
NOTES	1,2		
REF			
ISSUE			

FOR REVISION UPDATE PLEASE REFER TO HISTORY OF CHANGES.

 Carsem Your Technology Partner

REV
B

DWG NO: -8MLPDH5X6M-CPOD-0039

APP'D	-
CHECKED	KC LAU
DESIGNED	-
DRAWN	WL ONG

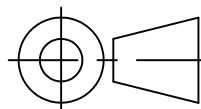

FILE:-8MLPDH5X6M-CPOD-0039-REVB

MLPDH 5X6 8L
PACKAGE OUTLINE
(CUCLIP)

PAGE : 3 of 5

SUMMARY TABLE 5

1.27mm PITCH VARIATION

SYMBOL										NOTE
b MIN	0.35									
b NOM	0.40									
b MAX	0.47									
D BSC	5.00									
D1 BSC	4.75									
D2 MIN	4.10									
D2 NOM	4.20									
D2 MAX	4.30									
E BSC	6.00									
E1 BSC	5.75									
E2 MIN	3.38									
E2 NOM	3.48									
E2 MAX	3.58									
E4 MIN	2.48									
E4 NOM	2.58									
E4 MAX	2.68									
L MIN	0.70									
L NOM	0.80									
L MAX	0.90									
N	8									
ND	4									
R REF	0.20									
R1 REF	0.10									
R2 MIN	0.15									
R2 NOM	0.20									
R2 MAX	0.25									
VARV	AA									
NOTE	1,2,9									3
REF										6
ISSUE										

FOR REVISION UPDATE PLEASE REFER TO HISTORY OF CHANGES.

 **Carsem** Your Technology Partner

REV
B

DWG NO: -8MLPDH5X6M-CPOD-0039

APP'D	-
CHECKED	KC LAU
DESIGNED	-
DRAWN	WL ONG

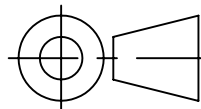

FILE:-8MLPDH5X6M-CPOD-0039-REVB

MLPDH 5X6 8L
PACKAGE OUTLINE
(CUCLIP)

PAGE : 4 of 5

Note:

1. Dimensioning and tolerancing conform to ASME Y14.5M-1994.
2. All dimensions are in millimeters . All angles are in degrees.
3. N is the total number of terminals.
4. The terminal #1 identifier and terminal numbering convention shall conform to JESD 95-1 SPP-012. Details of terminal #1 identifier are optional , but must be located within the zone indicated. The terminal #1 identifier may be a molded, marked, or metalized features.
5. Dimensions b apply to metallized terminal and is measured between 0.15 and 0.30mm from terminal tip.
6. ND refer to the maximum number of terminals on D side.
7. Depopulation of terminals is allowed and will be called out on the individual variations.
8. Figure 1 shown in page 1 of 5 is for illustration only.
9. For a complete set of dimensions for each variation, see the individual variation and the common dimensions and tolerances on page 3 & 4.
10. Coplanarity applies to the exposed heat sink slug as well as the terminals.

FOR REVISION UPDATE PLEASE REFER TO HISTORY OF CHANGES.

 Carsem Your Technology Partner

REV
B

DWG NO: -8MLPDH5X6M-CPOD-0039

APP'D	-
CHECKED	KC LAU
DESIGNED	-
DRAWN	WL ONG

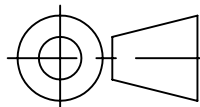

FILE:-8MLPDH5X6M-CPOD-0039-REVB

MLPDH 5X6 8L
PACKAGE OUTLINE
(CUCLIP)

PAGE : 5 of 5