

SUMMARY			
BODY WIDTH	LEAD PITCH	LEAD COUNT	VARIATIONS
4.40	0.65	8	AA
		14	AB-1
		14	AB-1T (THERMALLY ENHANCED VARIATION)
		16	AB
		16	ABT-1 (THERMALLY ENHANCED VARIATION)
		20	AC
		20	ACT-1 (THERMALLY ENHANCED VARIATION)
		24	AD
		24	ADT-1 (THERMALLY ENHANCED VARIATION)
		24	ADT-2 (THERMALLY ENHANCED VARIATION)
		28	AE
		28	AET-1 (THERMALLY ENHANCED VARIATION)
		28	AET-2 (THERMALLY ENHANCED VARIATION)
		6.10	0.50
0.50	48		ED
		56	EE

FOR REVISION UPDATE PLEASE REFER TO HISTORY OF CHANGES.

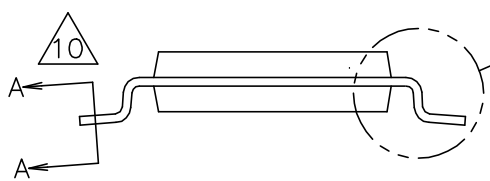

<b>REV</b>  <b>A</b>				DWG NO : PKGTS0002
	ORIGINATOR			TSSOP PACKAGE OUTLINE ( CUSTOMER SPEC )
	REQUESTOR			
	TOOLING DEPT MANAGER			
	DATE GENERATED	2025 JUN 09		PAGE: 1 OF 7

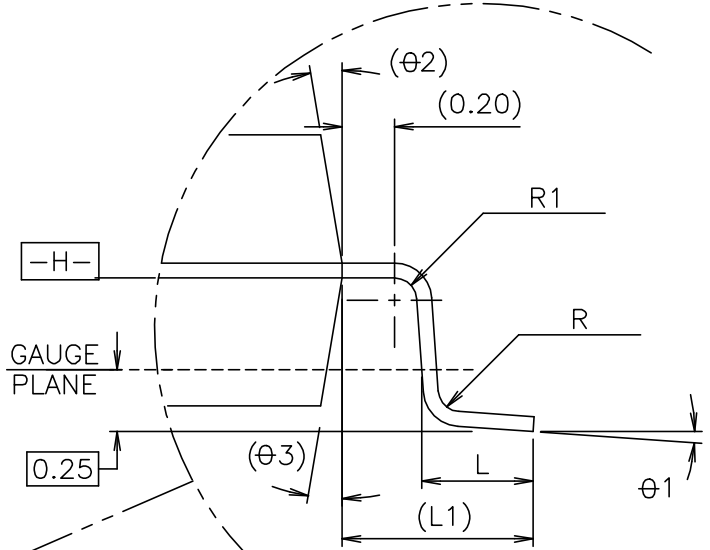
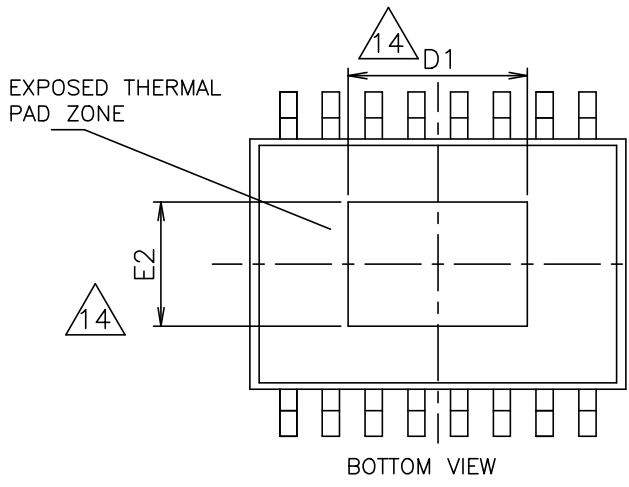
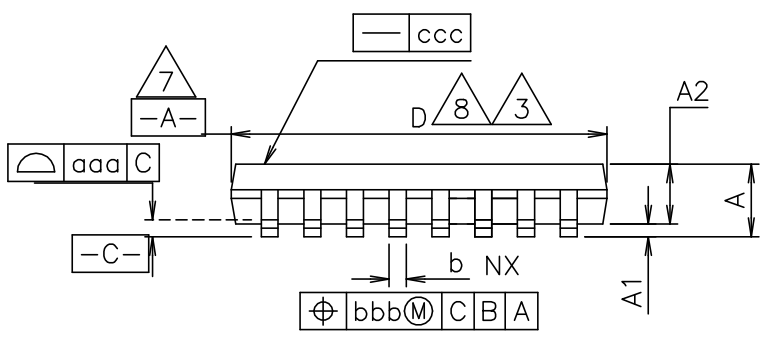
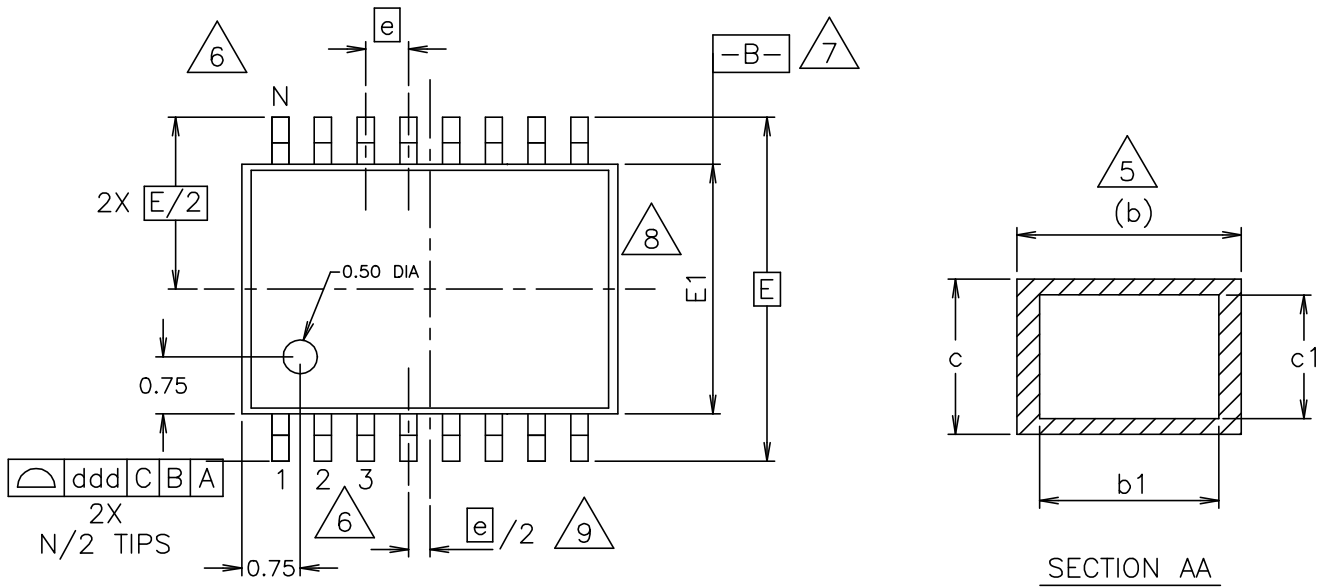

FOR REVISION UPDATE PLEASE REFER TO HISTORY OF CHANGES.

**Carsem** Your Technology Partner

REV  
**A**

ORIGINATOR	
REQUESTOR	
TOOLING DEPT MANAGER	
DATE GENERATED	2025 JUN 09

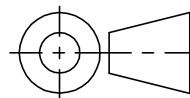

DWG NO : PKGTS0002  
TSSOP PACKAGE OUTLINE  
( CUSTOMER SPEC )  
PAGE: 2 OF 7

SYMBOL	COMMON DIMENSION(MILLIMETERS)							
	0.65mm LEAD PITCH			NOTE	0.50mm LEAD PITCH			NOTE
	MIN	NOM	MAX		MIN	NOM	MAX	
A	---	---	1.10	---	---	---	1.10	---
A1	0.05	---	0.15	---	0.05	---	0.15	---
A2	0.85	0.90	0.95	---	0.85	0.90	0.95	---
L	0.50	0.60	0.75	---	0.45	0.60	0.75	---
R	0.09	---	---	---	0.09	---	---	---
R1	0.09	---	---	---	0.09	---	---	---
b	0.19	---	0.30	5	0.17	---	0.27	5
b1	0.19	0.22	0.25	---	0.17	0.20	0.23	---
c	0.09	---	0.20	---	0.09	---	0.20	---
c1	0.09	---	0.16	---	0.09	---	0.16	---
$\theta 1$	0°	---	8°	---	0°	---	8°	---
L1	1.0 REF			---	1.0 REF			---
aaa	0.10			---	0.10			---
bbb	0.10			---	0.08			---
ccc	0.05			---	0.05			---
ddd	0.20			---	0.20			---
e	0.65 BSC			---	0.50 BSC			---
$\theta 2$	12° REF			---	12° REF			---
$\theta 3$	12° REF			---	12° REF			---
NOTE	1,2				1,2			
ISSUE	A				A			

FOR REVISION UPDATE PLEASE REFER TO HISTORY OF CHANGES.



REV  
A

ORIGINATOR	
REQUESTOR	
TOOLING DEPT MANAGER	
DATE GENERATED	2025 JUN 09

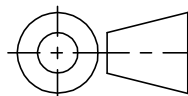

DWG NO : PKGTS0002
TSSOP PACKAGE OUTLINE ( CUSTOMER SPEC )
PAGE: 3 OF 7

NOTES:

- 1 ALL DIMENSIONS ARE IN MILLIMETERS (ANGLES IN DEGREES).
- 2 DIMENSIONING AND TOLERANCING PER ASME Y14.5M-1994.
- 3 DIMENSION 'D' DOES NOT INCLUDE MOLD FLASH, PROTRUSIONS OR GATE BURRS. MOLD FLASH, PROTRUSIONS OR GATE BURRS SHALL NOT EXCEED 0.15 PER SIDE.
- 4 DIMENSION 'E1' DOES NOT INCLUDE INTERLEAD FLASH OR PROTRUSION. INTERLEAD FLASH OR PROTRUSION SHALL NOT EXCEED 0.25 PER SIDE.
- 5 DIMENSION 'b' DOES NOT INCLUDE DAMBAR PROTRUSION. ALLOWABLE DAMBAR PROTRUSION SHALL BE 0.08 MM TOTAL IN EXCESS OF THE 'b' DIMENSION AT MAXIMUM MATERIAL CONDITION. DAMBAR CANNOT BE LOCATED ON THE LOWER RADIUS OF THE FOOT. MINIMUM SPACE BETWEEN PROTRUSION AND ADJACENT LEAD IS 0.07 MM FOR 0.5 MM PITCH PACKAGES.
- 6 TERMINAL NUMBERS ARE SHOWN FOR REFERENCE ONLY.
- 7 DATUMS [-A-] AND [-B-] TO BE DETERMINED AT DATUM PLANE [-H-].
- 8 DIMENSIONS 'D' AND 'E1' ARE TO BE DETERMINED AT DATUM PLANE [-H-].
- 9 THIS DIMENSION APPLIES ONLY TO VARIATIONS WITH AN EVEN NUMBER OF LEADS PER SIDE. FOR VARIATION WITH AN ODD NUMBER OF LEADS PER SIDE, THE "CENTER" LEAD MUST BE COINCIDENT WITH THE PACKAGE CENTERLINE, DATUM A.
- 10 CROSS SECTION A-A TO BE DETERMINED AT 0.10 TO 0.25 MM FROM THE LEAD TIP.
- 11 THIS VARIATION IS NOT REGISTERED WITH JEDEC.
- 12 PACKAGE SURFACE FINISHING:
  - (I) TOP: MATTE (CHARMILLES: #18~30)
  - (II) BOTTOM: MATTE (CHARMILLES: #12~27)
13. 'N' IS THE MAXIMUM NUMBER OF TERMINAL POSITIONS FOR THE SPECIFIED PACKAGE LENGTH. DEPOPULATION IS ALLOWED, BUT ONLY UNDER THE FOLLOWING CONDITIONS :
  - A) DEPOPULATION MAY REDUCE 'N' BY INCREMENTS OF FOUR (4) LEADS ONLY
  - B) ONLY END LEADS MAY BE REMOVED
  - C) LEADS MUST BE SYMMETRICALLY ARRANGED WITH RESPECT TO DATUM A (SEE NOTE 10) TO AVOID ANY ARRAY SHIFTING.
14. 'D1' AND 'E2' MINIMUM DIMENSIONS OF THERMALLY ENHANCED TYPES ARE VARIABLES DEPENDING ON DEVICE FUNCTION (DIE PADDLE SIZE). 'D1' AND 'E2' MAXIMUM DIMENSIONS CAN BE EQUAL TO 'D/E1' MAXIMUM DIMENSIONS. END USER SHOULD VERIFY ACTUAL SIZE OF EXPOSED THERMAL PAD FOR SPECIFIC DEVICE APPLICATION.

FOR REVISION UPDATE PLEASE REFER TO HISTORY OF CHANGES.



<b>REV</b>  <b>A</b>	ORIGINATOR			DWG NO : PKGTS0002
	REQUESTOR			TSSOP PACKAGE OUTLINE ( CUSTOMER SPEC )
	TOOLING DEPT MANAGER			
	DATE GENERATED	2025 JUN 09		PAGE: 4 OF 7

SYMBOL	VARIATIONS											
	AA			NOTE	AB-1			NOTE	AB-1T (Thermally Enhanced Variation)			NOTE
	MIN	NOM	MAX		MIN	NOM	MAX		MIN	NOM	MAX	
D	2.90	3.0	3.10	3,8	4.90	5.00	5.10	3,8	4.90	5.00	5.10	3,8
D1	-	-	-		-	-	-		3.00	3.10	3.20	14
E1	4.30	4.40	4.50	4,8	4.30	4.40	4.50	4,8	4.30	4.40	4.50	4,8
E2	-	-	-		-	-	-		2.90	3.00	3.10	14
E	6.4 BSC				6.4 BSC				6.4 BSC			
e	0.65 BSC				0.65 BSC				0.65 BSC			
N	8			6	14			6	14			6
NOTE	1,2				1,2				1,2			
ISSUE	A				C				C			

SYMBOL	VARIATIONS											
	AB			NOTE	ABT-1			NOTE	AC			NOTE
	MIN	NOM	MAX		MIN	NOM	MAX		MIN	NOM	MAX	
D	4.90	5.00	5.10	3,8	4.90	5.00	5.10	3,8	6.40	6.50	6.60	3,8
D1	-	-	-		2.90	3.00	3.10	14	-	-	-	
E1	4.30	4.40	4.50	4,8	4.30	4.40	4.50	4,8	4.30	4.40	4.50	4,8
E2	-	-	-		2.90	3.00	3.10	14	-	-	-	
E	6.4 BSC				6.4 BSC				6.4 BSC			
e	0.65 BSC				0.65 BSC				0.65 BSC			
N	16			6	16			6	20			6
NOTE	1,2				1,2				1,2			
ISSUE	A				A				A			

SYMBOL	VARIATIONS											
	ACT-1 (Thermally Enhanced Variation)			NOTE	AD			NOTE	ADT-1 (Thermally Enhanced Variation)			NOTE
	MIN	NOM	MAX		MIN	NOM	MAX		MIN	NOM	MAX	
D	6.40	6.50	6.60	3,8	7.70	7.80	7.90	3,8	7.70	7.80	7.90	3,8
D1	4.09	4.19	4.29	14	-	-	-		5.41	5.51	5.61	14
E1	4.30	4.40	4.50	4,8	4.30	4.40	4.50	4,8	4.30	4.40	4.50	4,8
E2	2.90	3.00	3.10	14	-	-	-		2.90	3.00	3.10	14
E	6.4 BSC				6.4 BSC				6.4 BSC			
e	0.65 BSC				0.65 BSC				0.65 BSC			
N	20			6	24			6	24			6
NOTE	1,2				1,2				1,2			
ISSUE	A				A				A			

FOR REVISION UPDATE PLEASE REFER TO HISTORY OF CHANGES.

 **Carsem** Your Technology Partner

REV  
A

ORIGINATOR  
REQUESTOR  
TOOLING DEPT MANAGER  
DATE GENERATED

2025 JUN 09

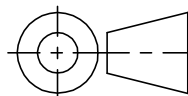

DWG NO : PKGTS0002

TSSOP PACKAGE OUTLINE  
( CUSTOMER SPEC )

PAGE: 5 OF 7

SYMBOL	VARIATIONS											
	ADT-2 (Thermally Enhanced Variation)			NOTE	AE			NOTE	AET-1			NOTE
	MIN	NOM	MAX		MIN	NOM	MAX		MIN	NOM	MAX	
D	7.70	7.80	7.90	3,8	9.60	9.70	9.80	3,8	9.60	9.70	9.80	3,8
D1	4.20	4.30	4.40	14	-	-	-		4.98	5.08	5.18	14
E1	4.30	4.40	4.50	4,8	4.30	4.40	4.50	4,8	4.30	4.40	4.50	4,8
E2	2.90	3.00	3.10	14	-	-	-		2.90	3.00	3.10	14
E	6.4 BSC				6.4 BSC				6.4 BSC			
e	0.65 BSC				0.65 BSC				0.65 BSC			
N	24			6	28			6	28			6
NOTE	1,2				1,2				1,2			
ISSUE	A				A				A			

SYMBOL	VARIATIONS											
	AET-2			NOTE	BD-1			NOTE	ED			NOTE
	MIN	NOM	MAX		MIN	NOM	MAX		MIN	NOM	MAX	
D	9.60	9.70	9.80	3,8	9.60	9.70	9.80	3,8	12.40	12.50	12.60	3,8
D1	5.40	5.50	5.60	14	-	-	-		-	-	-	
E1	4.30	4.40	4.50	4,8	4.30	4.40	4.50	4,8	6.00	6.10	6.20	4,8
E2	2.90	3.00	3.10	14	-	-	-		-	-	-	
E	6.4 BSC				6.4 BSC				8.1 BSC			
e	0.65 BSC				0.50 BSC				0.50 BSC			
N	28			6	38			6	48			6
NOTE	1,2				1,2,11				1,2			
ISSUE	A				---				A			

SYMBOL	VARIATIONS											
	EE			NOTE								
	MIN	NOM	MAX		MIN	NOM	MAX		MIN	NOM	MAX	
D	13.90	14.00	14.10	3,8								
D1	-	-	-									
E1	6.00	6.10	6.20	4,8								
E2	-	-	-									
E	8.1 BSC											
e	0.50 BSC											
N	56			6								
NOTE	1,2											
ISSUE	A											

FOR REVISION UPDATE PLEASE REFER TO HISTORY OF CHANGES.



REV  
A

ORIGINATOR	
REQUESTOR	
TOOLING DEPT MANAGER	
DATE GENERATED	2025 JUN 09

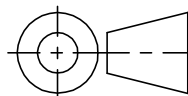

DWG NO : PKGTS0002  
TSSOP PACKAGE OUTLINE  
( CUSTOMER SPEC )  
PAGE: 6 OF 7

